



Majestic View

TERRACES AT SAN MARTIN







LOCATION



THE TERRACES AT SAN MARTIN

Escaleras, Bahía Ballena,
Osa, Puntarenas

Specifications:



24.00 m² | 258.33 ft²

Master Bedroom



7.50 m² | 18.84 ft²

Master Bathroom



10.50 m² | 113.65 ft²

Bedroom



5.52 m² | 59.45 ft²

Bathroom



6.23 m² | 67.03 ft²

Laundry room



6.30 m² | 67.81 ft²

Hallway



8.10 m² | 87.19 ft²

Kitchen



18.92 m² | 203.68 ft²

Living room



30.80 m² | 331.50 ft²

Garage



12.40 m² | 133.45 ft²

Dinning room



73.64 m² | 792.65 ft²

Terrace

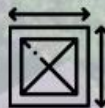

197.56 m² | 2,126.53 ft²

TOTAL BUILT AREA



PRICE:
\$ 525,000

AREA:
329.21 m²
3,543.58 ft²



EXTERIOR



















INTERIOR

















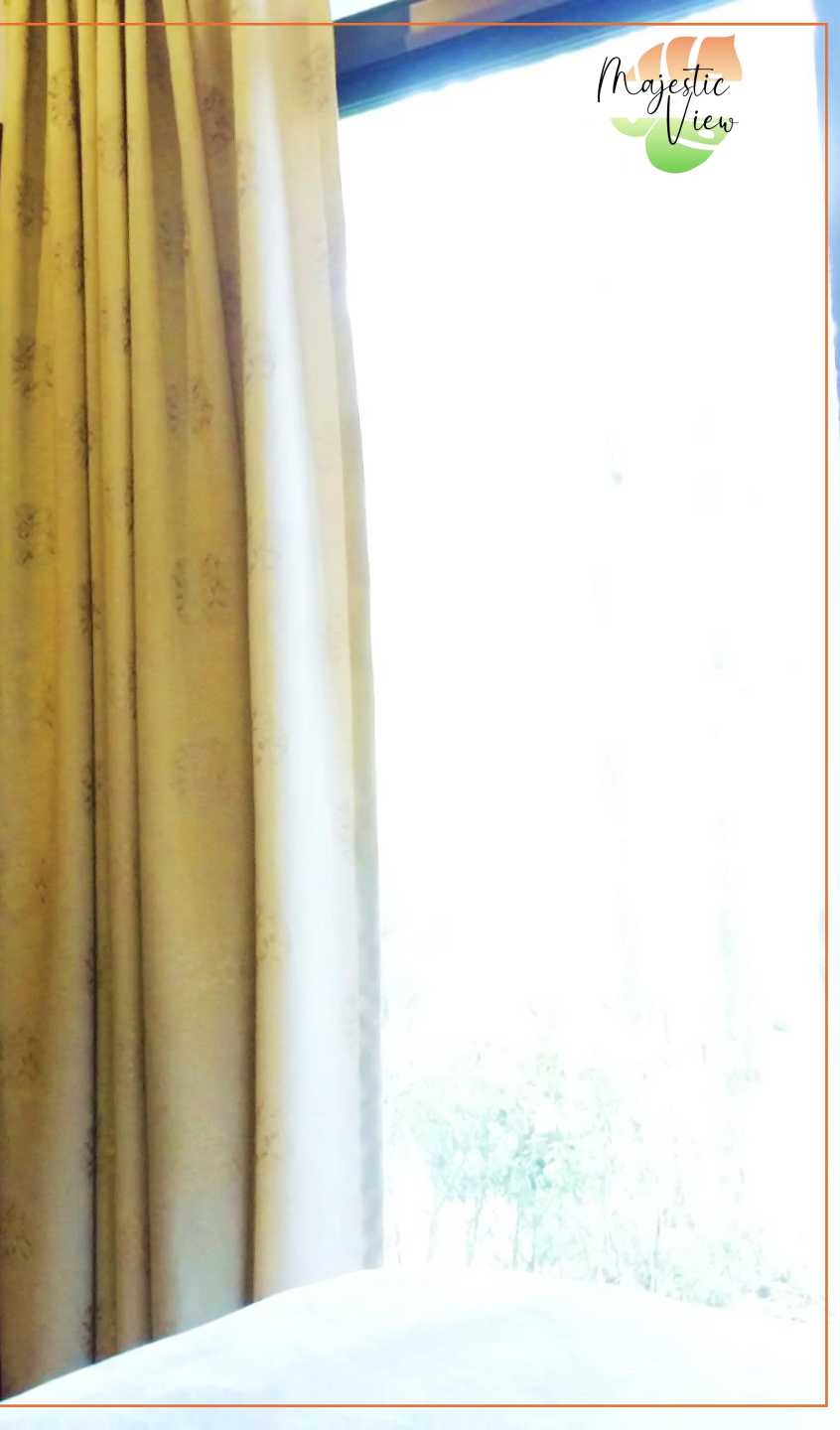







OCEAN VIEW

Puerto Nuevo Beach, Domaticalito



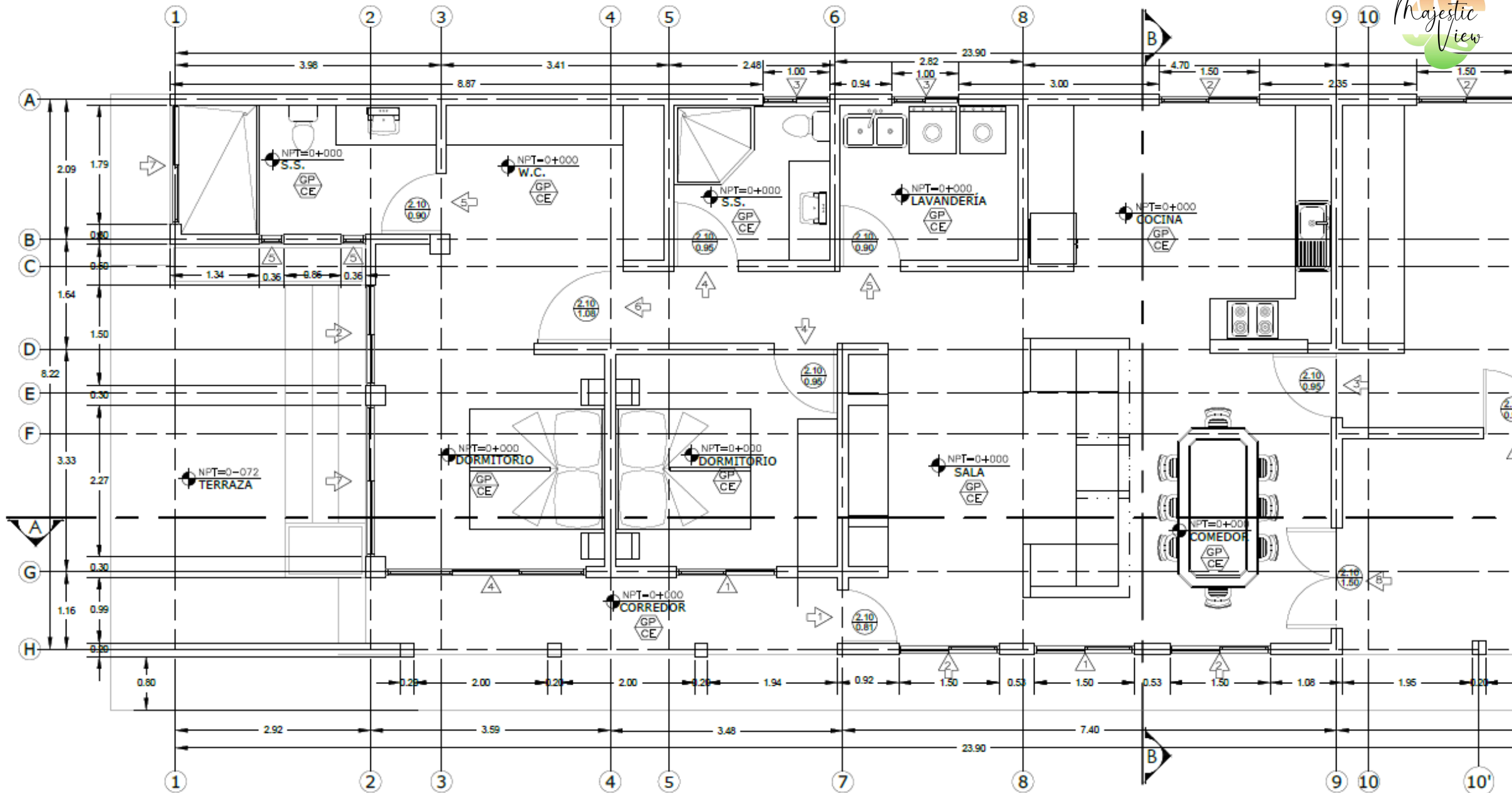

LEVANTAMIENTO PLANTA DE DISTRIBUCIÓN ARQUITECTÓNICA.

ESC. 1:30



Majestic View



THE TERRACES
AT SAN MARTÍN

axiom
REAL ESTATE GROUP



Contact us



For rent:

Camila Vargas
Concierge
+506 7300 8191

cuargas@axiomcostarica.com

For sales:

Tony Calvo
Sales Agent
+506 7111 4306

tcalvo@axiomcostarica.com